

65 INFANTERÍA SHOPPING CENTER



Anchor Stores	Supermercado Plaza Loiza, Walgreens, PETCO, Pepe Ganga
National & Local Tenants	Me Salvé, Banco Popular, Exentrix
Hours of Operation	Mon - Sat: 9am - 6pm / Sun: 11am - 7pm
Location	Corner of Barbosa Ave. & SR. 3, Río Piedras, Puerto Rico
Parking Spaces	588
Gross Leasable Area	146,048 Sq. Ft.



	1 mile	3 miles	5 miles	
Population	29,177	225,101	484,042	Estimated Census Numbers for Year 2021
Households	12,410	92,653	197,447	
Average Income	\$34,668	\$39,709	\$47,682	

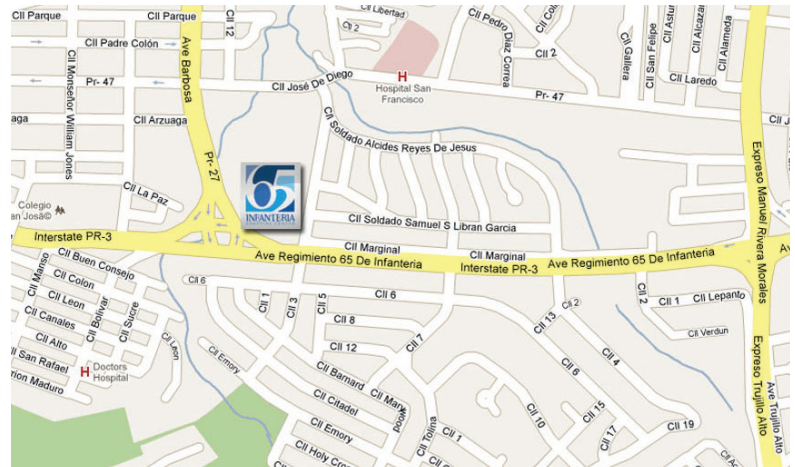

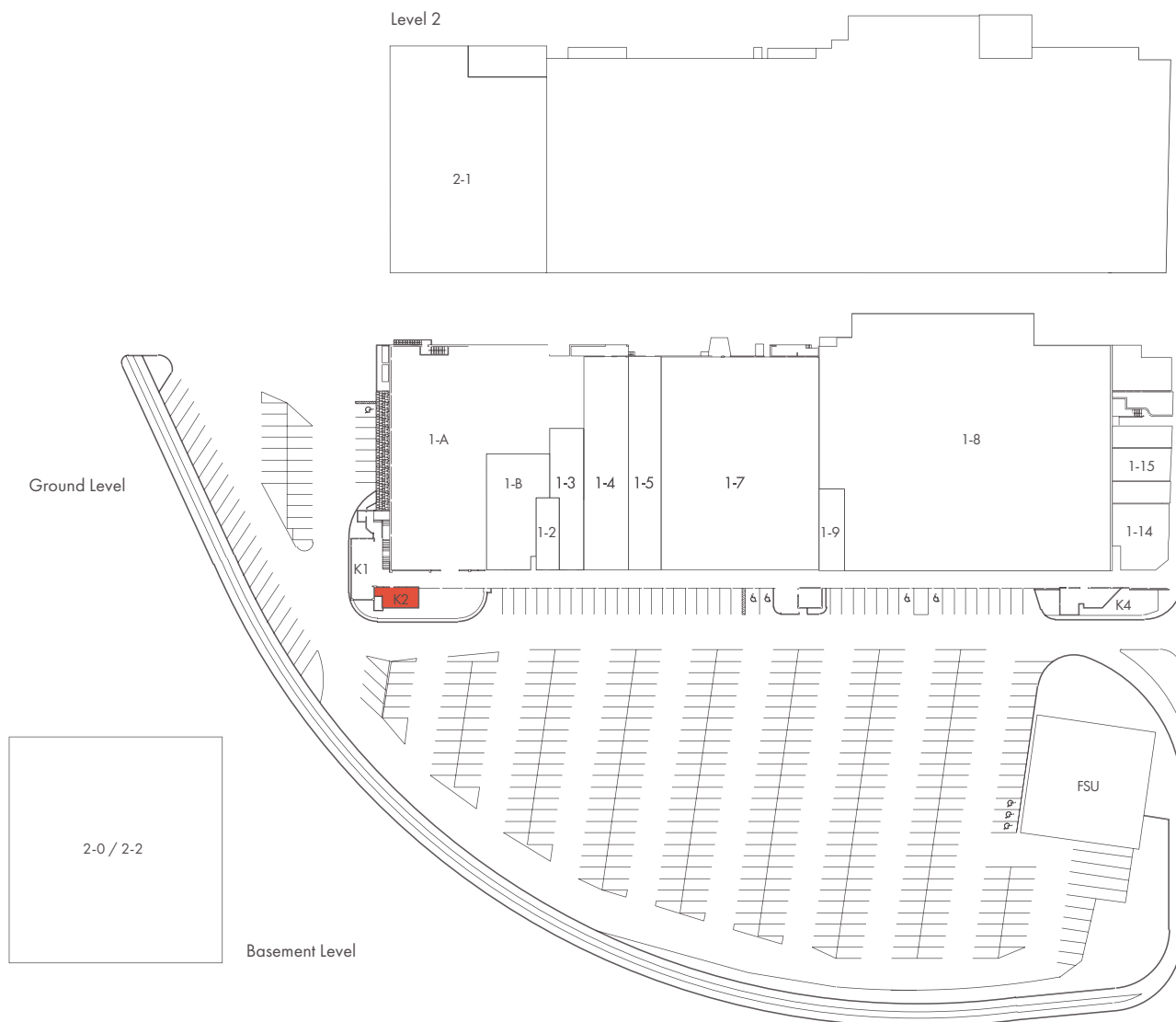

Unit	Sq Ft	Name	Unit	Sq Ft	Name	Unit	Sq Ft	Name
1-14	1,700	Subway	1-8	33,109	Plaza Loiza	FSU	5,100	Banco Popular
1-15	1,527	Wing Stop	1-9	920	Good Vision	K-1	699	Security Mall Office
1-2	1,080	Exentrix	1-A	11,275	PETCO	K-2	416	AVAILABLE
1-3	2,361	Little Caesars	1-B	5,252	Me Salvé	K-4	1,021	Metro PCS
1-4	4,356	Chulerías	2-0/2-2	25,361	Pepe Ganga			
1-5	3,026	Sally Beauty	2-1	14,655	Departamento de la Familia			
1-7	22,203	Walgreen's						

FOR LEASING OPPORTUNITIES PLEASE CONTACT US AT:

T 787 622 9600 x.120 / 145 / 116 / 154
PO Box 362983, San Juan, Puerto Rico 00936-2983

Plaza Caparra, Suite 201
1498 Roosevelt Ave. & Parkside St.
Guaynabo, Puerto Rico 00968

ymelendez@ccmpr.com
mfvelez@ccmpr.com

www.ccmpr.com

